

# LECTURE

## Room Setups in the University Commons

\*Please note that adding additional furniture to the room will decrease the listed capacities.

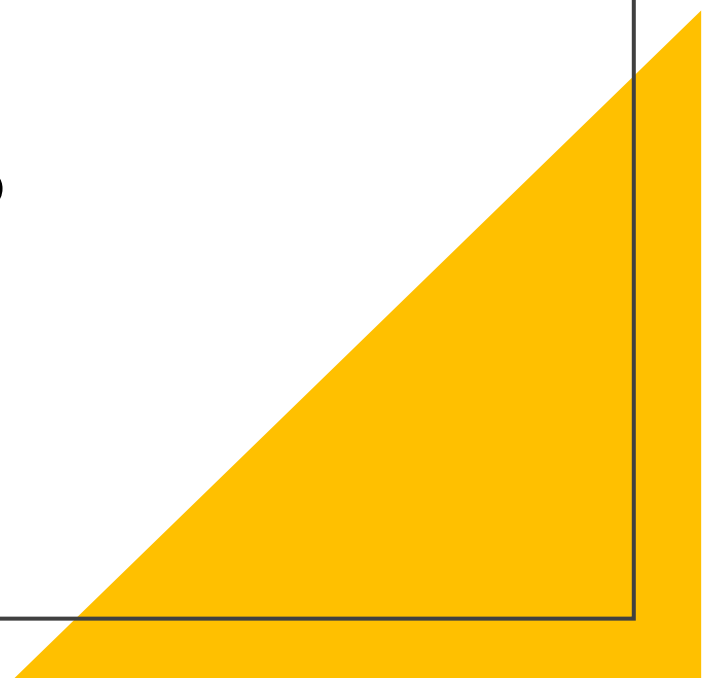

Multi-Purpose Room  
Student Center, 1<sup>st</sup> Floor

# LECTURE

Capacity - 192

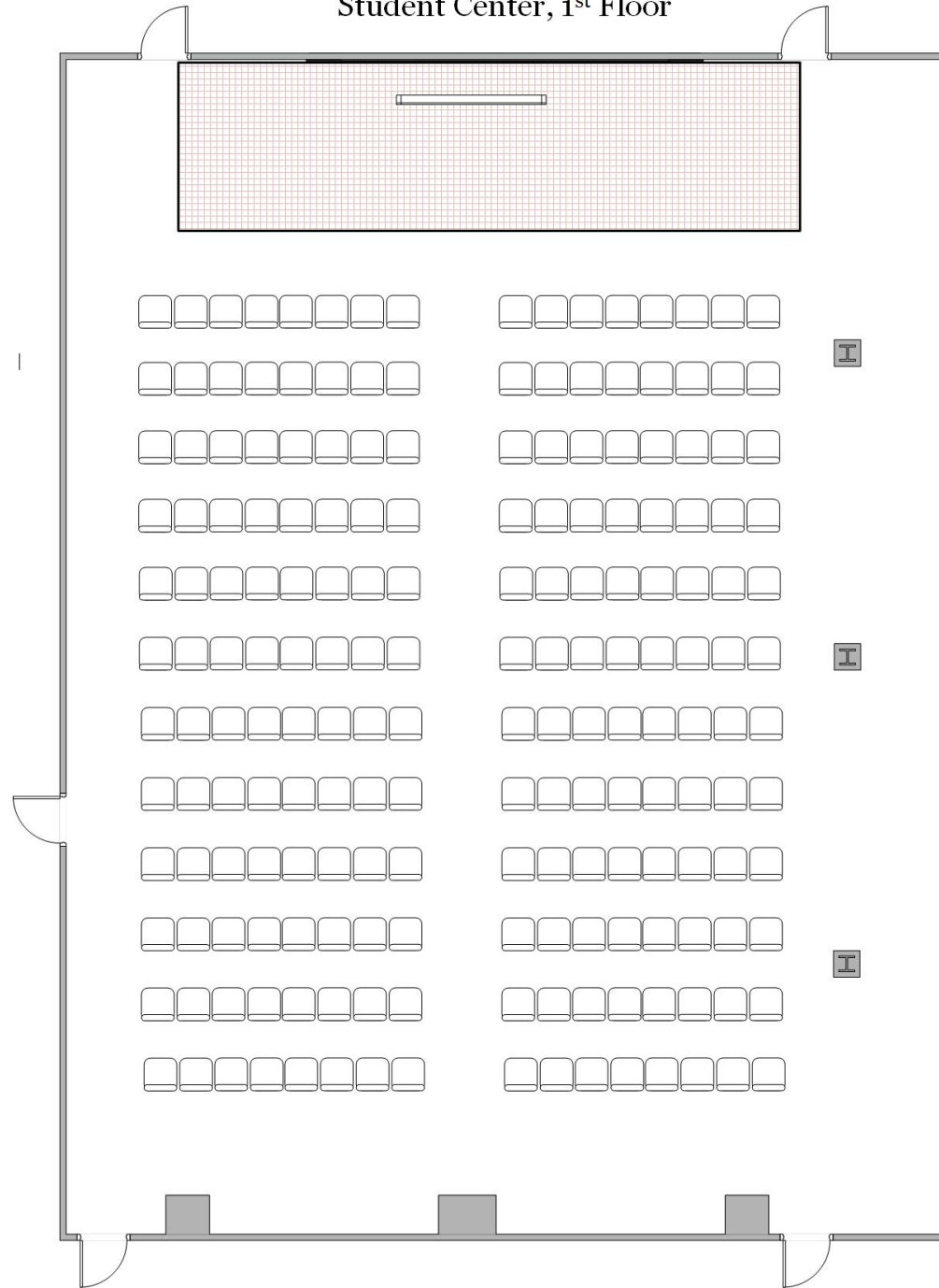

# LECTURE

Diagram shows  
168A and 168B as  
two separate rooms

168A  
Capacity - 50

168B  
Capacity - 45

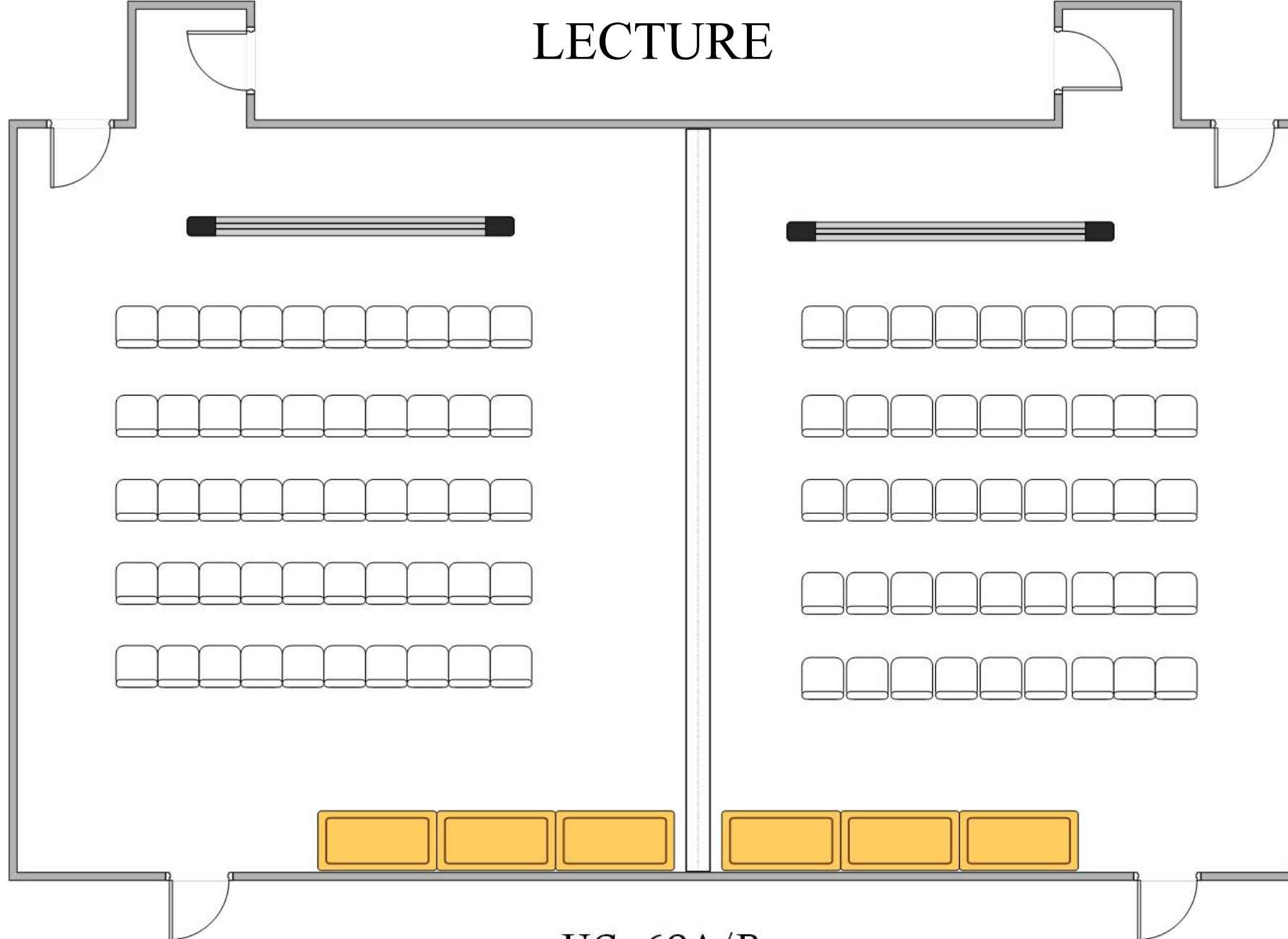

UC 168A/B  
Ballroom Building, 1<sup>st</sup> Floor

# LECTURE

168AB  
Capacity – 110

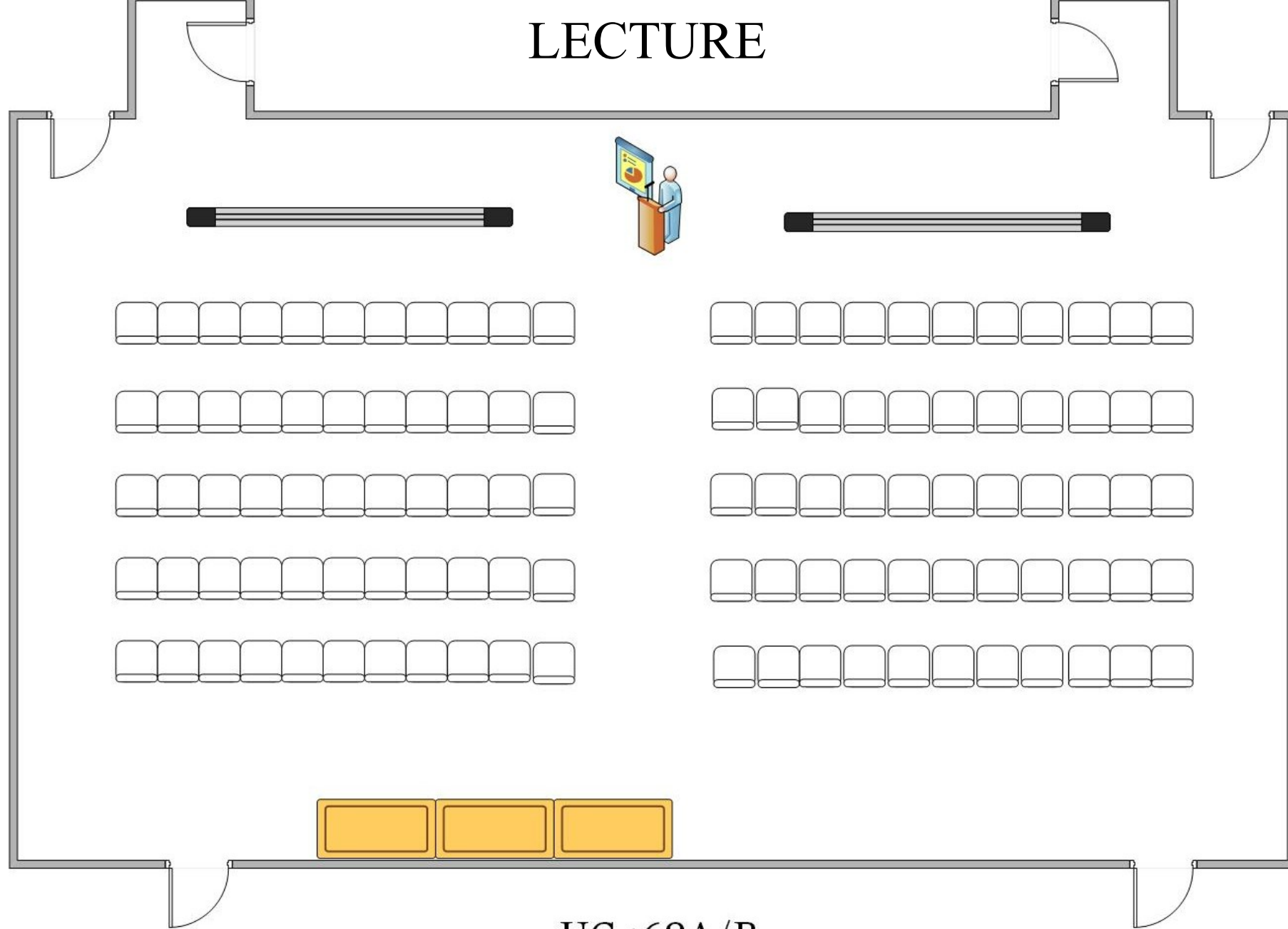

UC 168A/B  
Ballroom Building, 1<sup>st</sup> Floor

Diagram shows  
171A and 171B as  
two separate rooms

# LECTURE

171A  
Capacity - 50

171B  
Capacity - 70

UC 171A/B  
Ballroom Building, 1<sup>st</sup> Floor

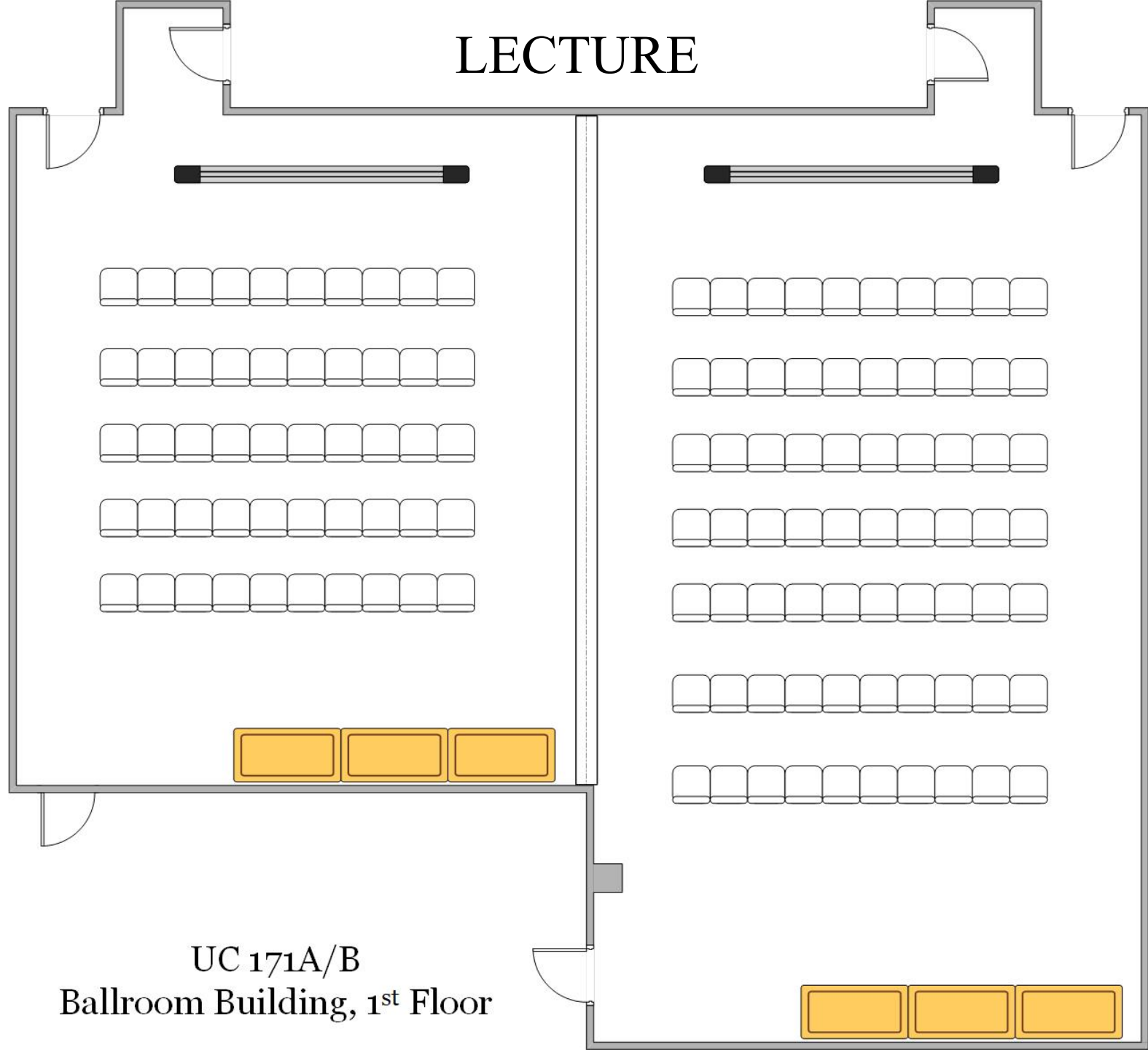

# LECTURE

171AB  
Capacity - 110

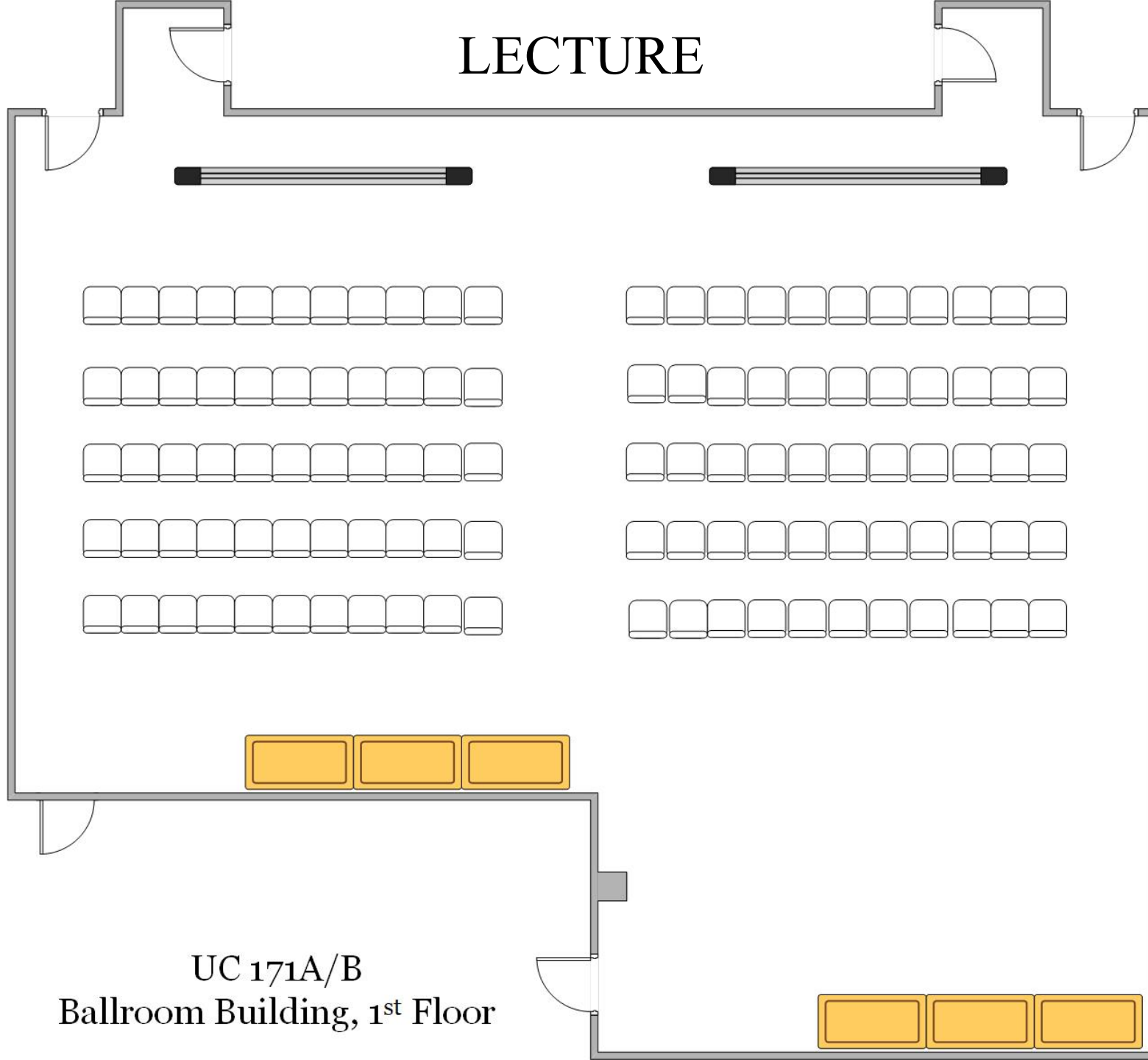

UC 171A/B  
Ballroom Building, 1<sup>st</sup> Floor

# LECTURE

Diagram shows  
BALLROOM A,  
BALLROOM B, AND  
BALLROOM C  
as separate rooms

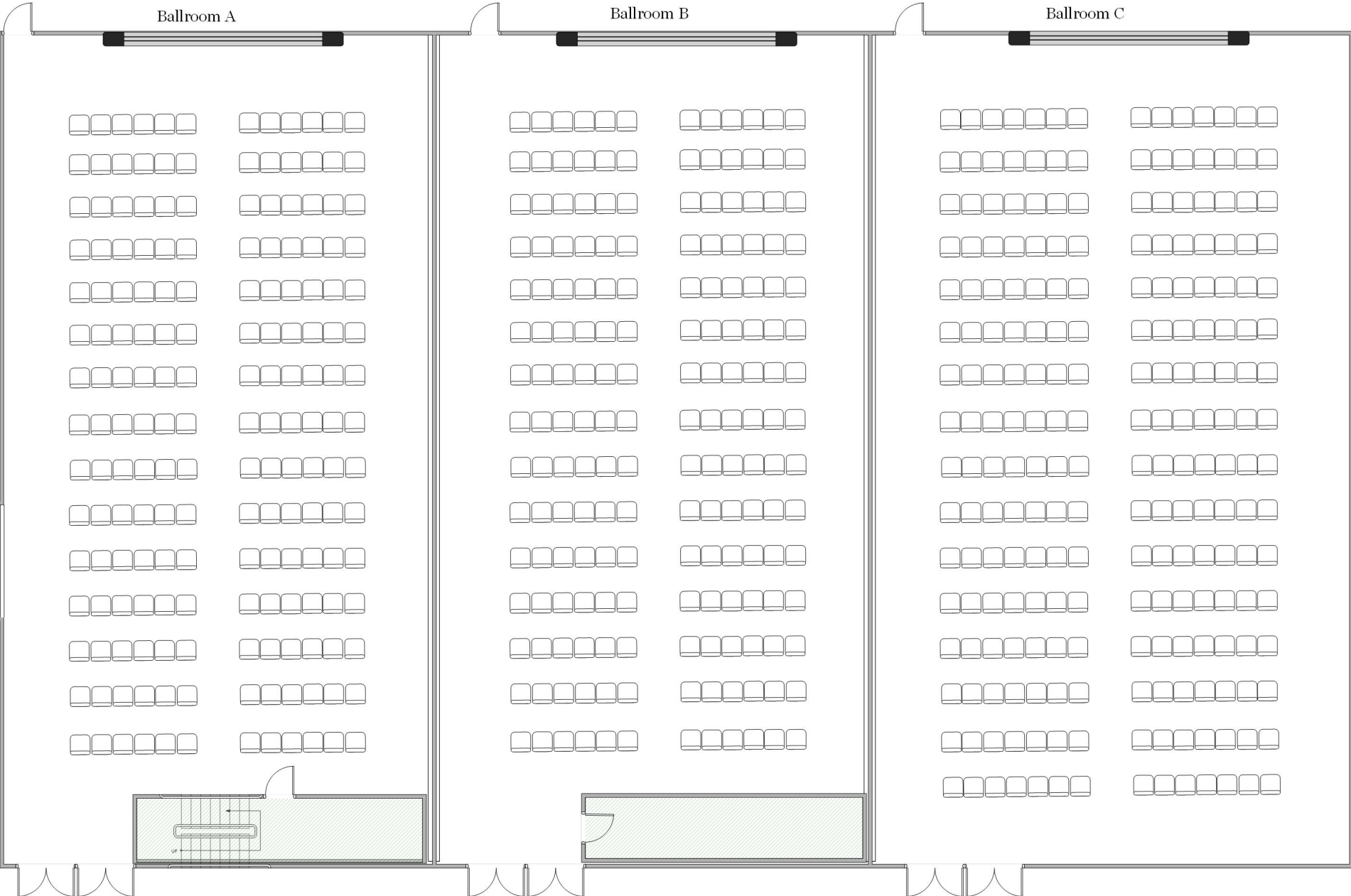

Ballroom A  
Capacity – 180

Ballroom B  
Capacity – 180

Ballroom C  
Capacity - 224

# LECTURE

Diagram shows BALLROOM C as a separate room

Ballroom C  
Facing north  
Capacity - 224

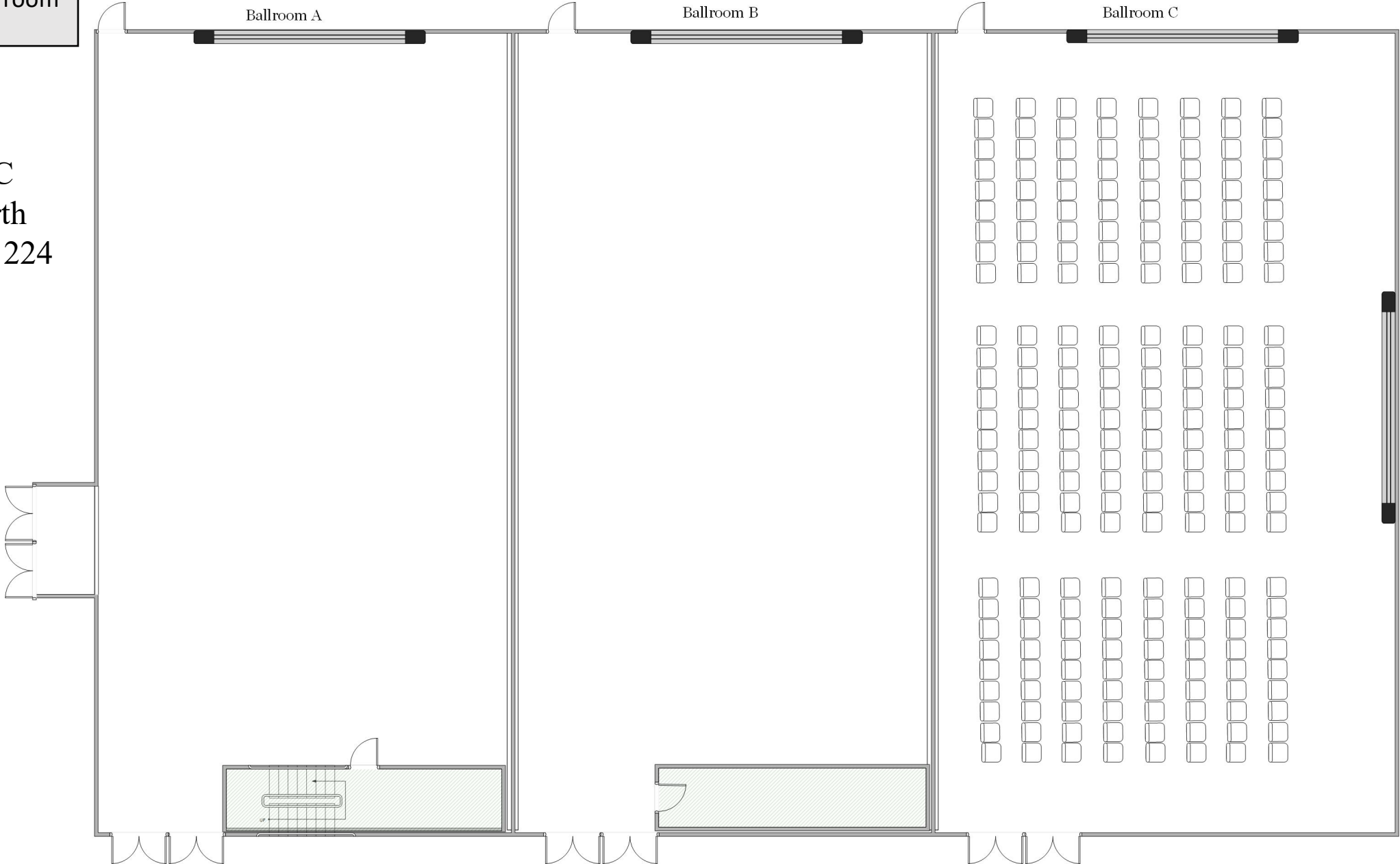



# LECTURE

Diagram shows BALLROOM AB as a separate room

Ballroom AB  
Capacity – 420

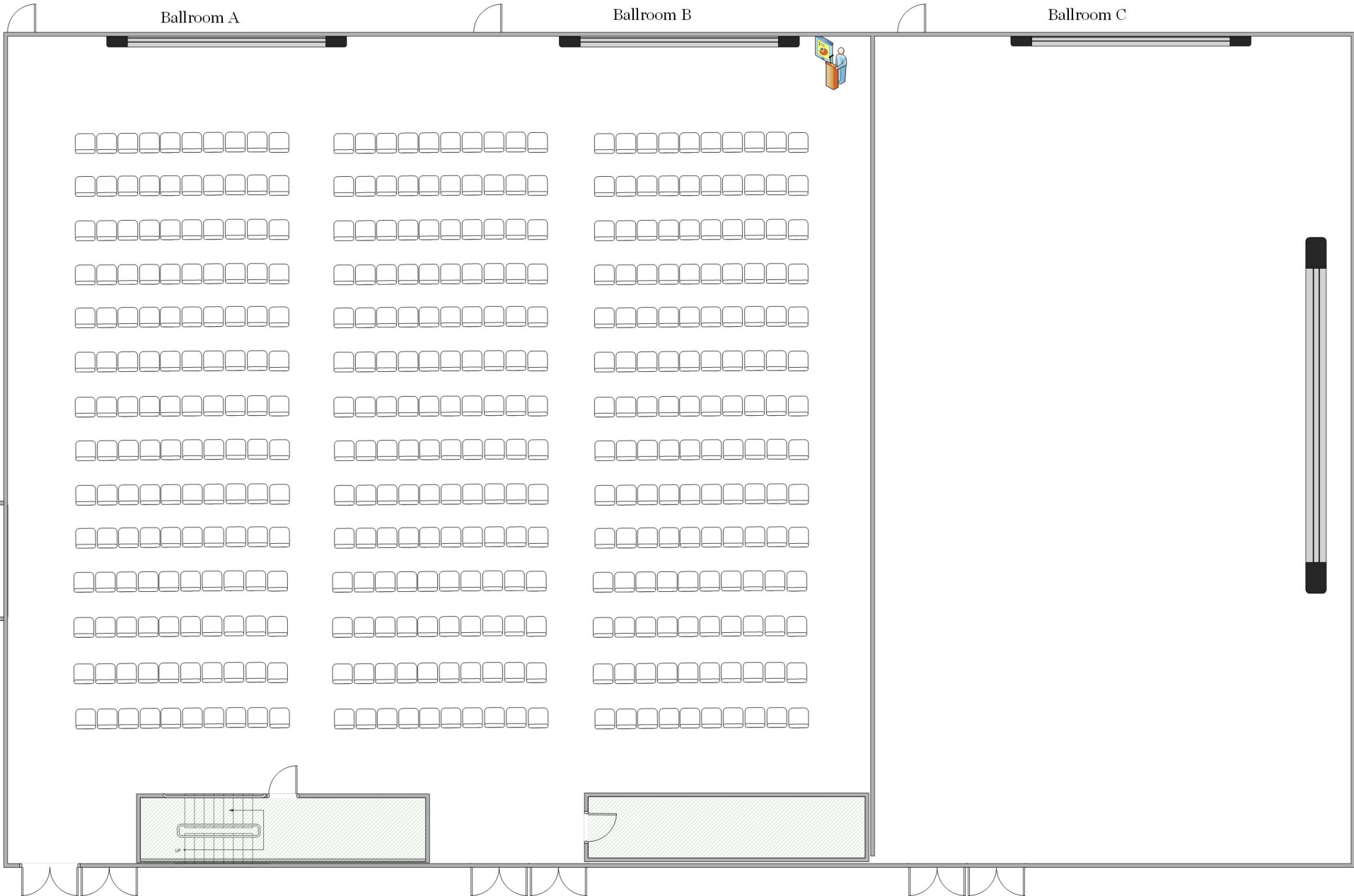

# LECTURE

Diagram shows BALLROOM BC as a separate room

Ballroom BC  
Facing North  
Capacity - 400

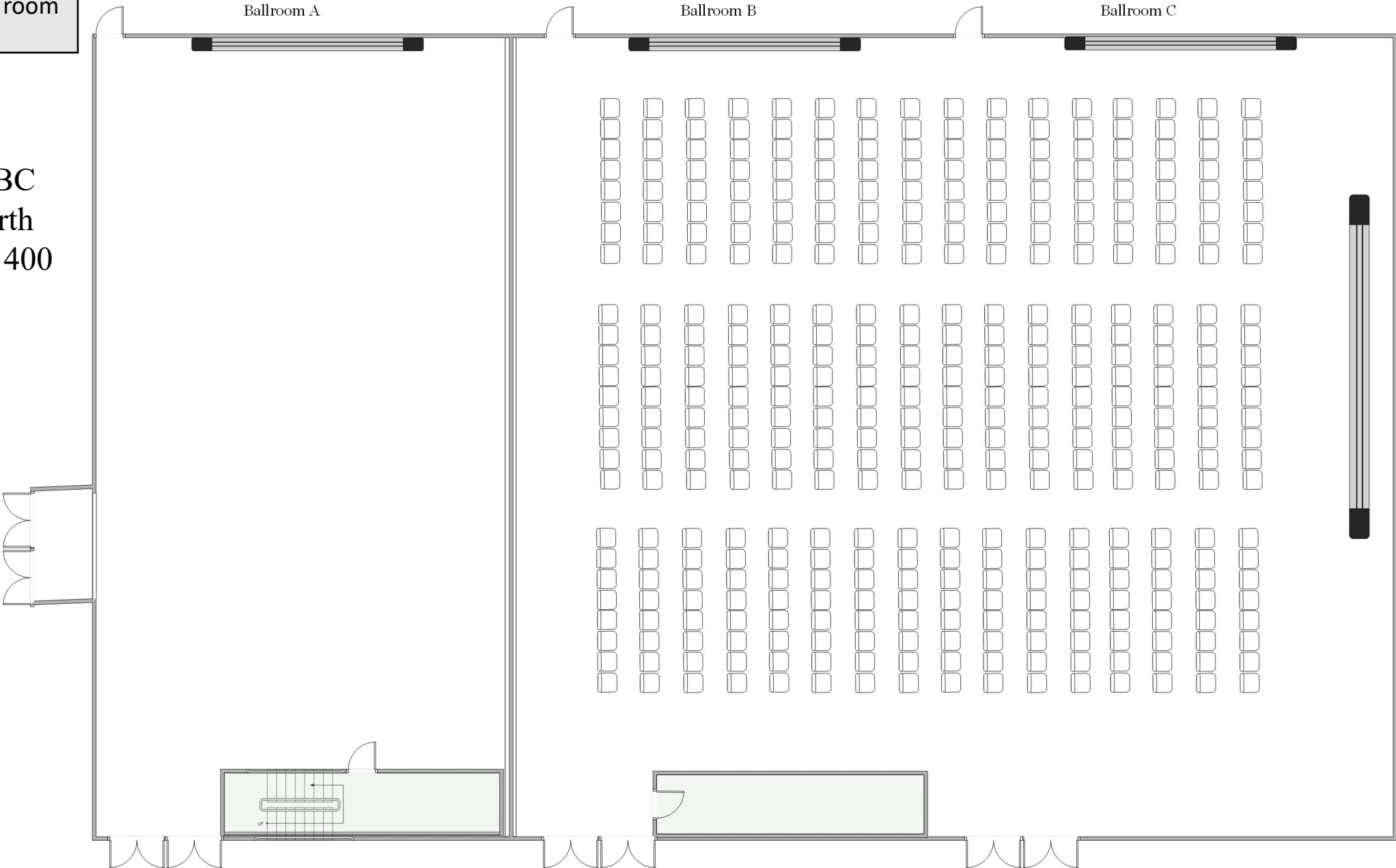

# LECTURE

Diagram shows BALLROOM BC as a separate room

Ballroom BC  
Facing walls  
Capacity - 448

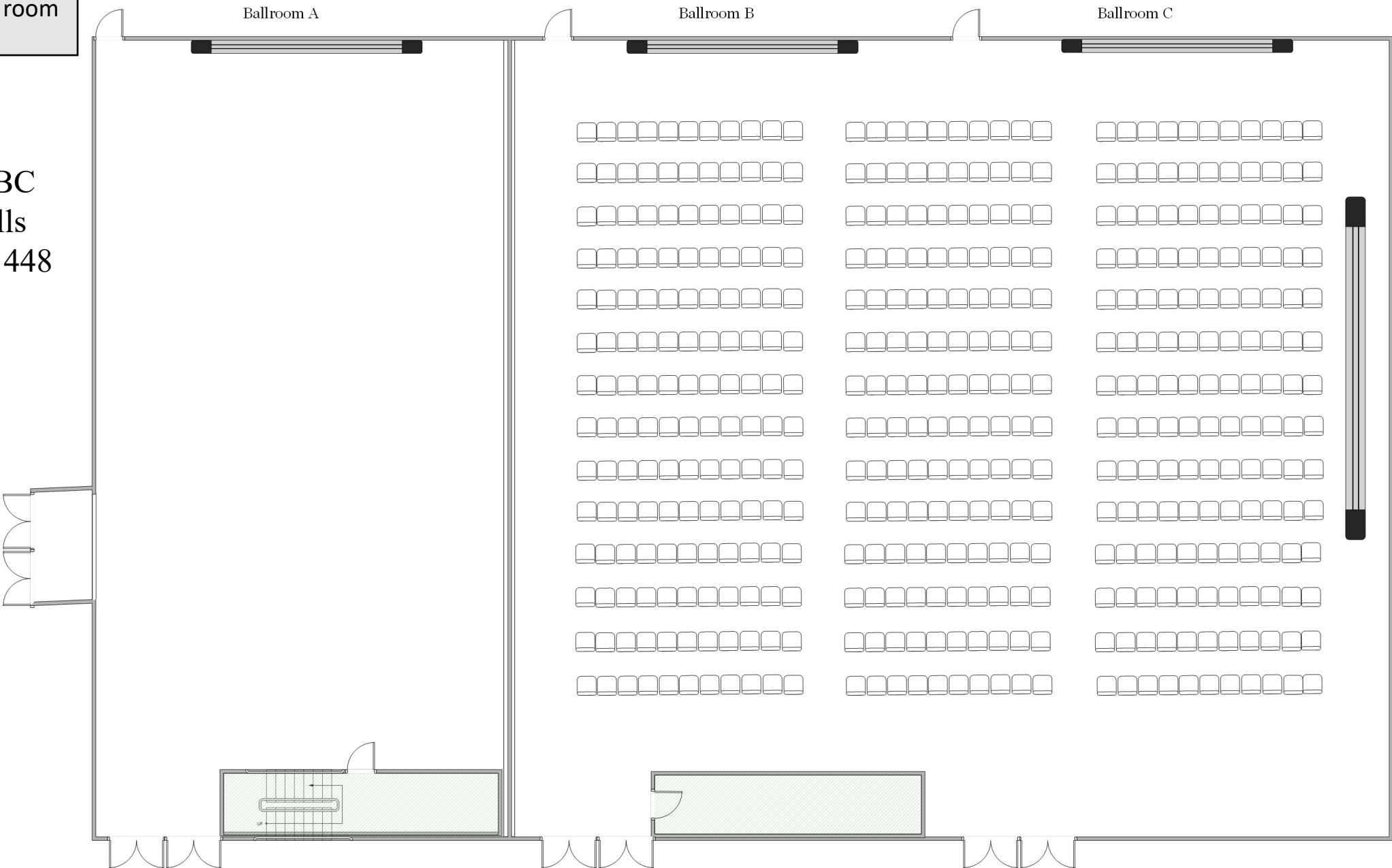

# LECTURE

Ballroom ABC  
Facing walls  
Capacity - 672

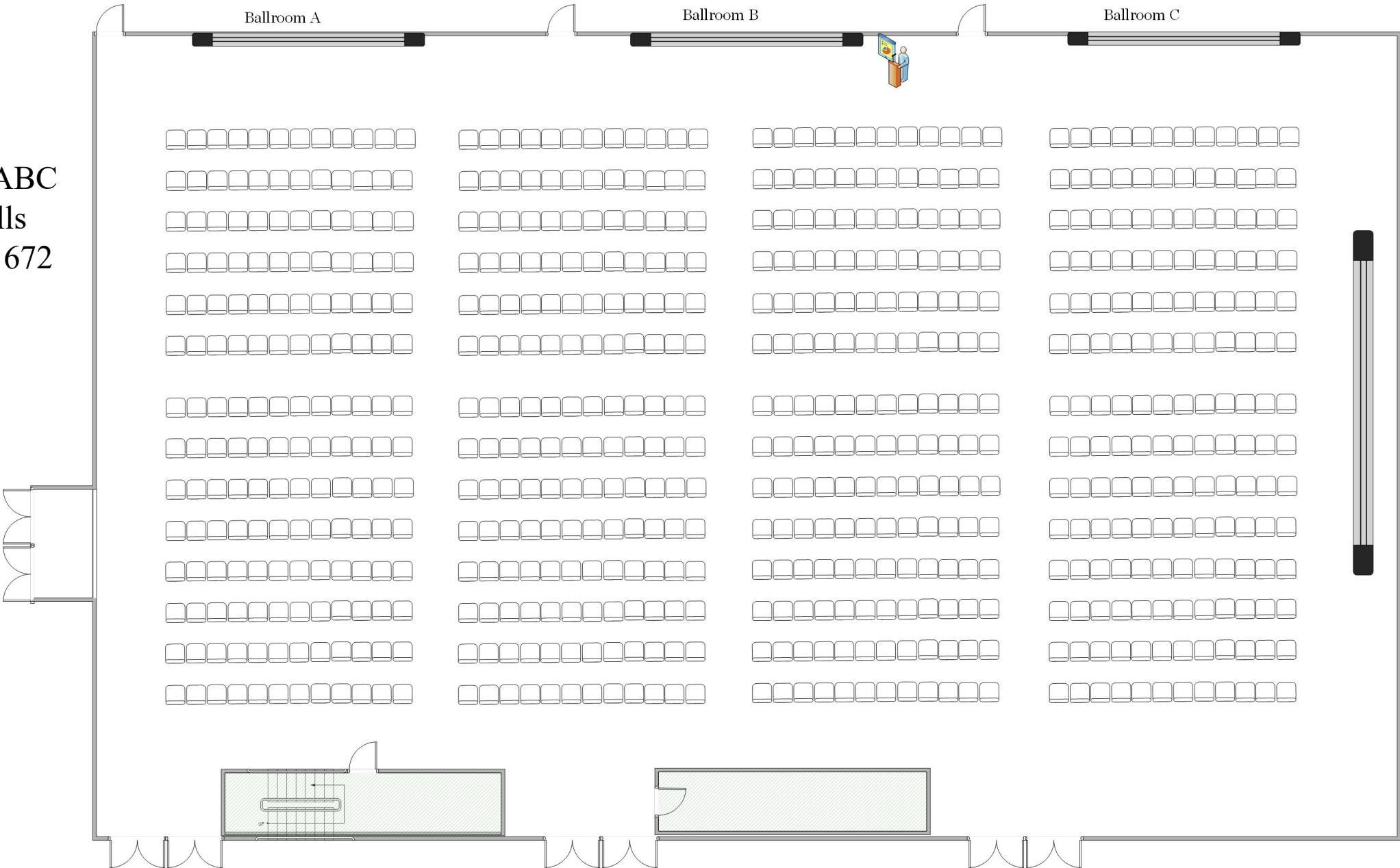

# LECTURE

Ballroom ABC  
Facing North  
Capacity - 648

